

patient commission/configuration ID _____

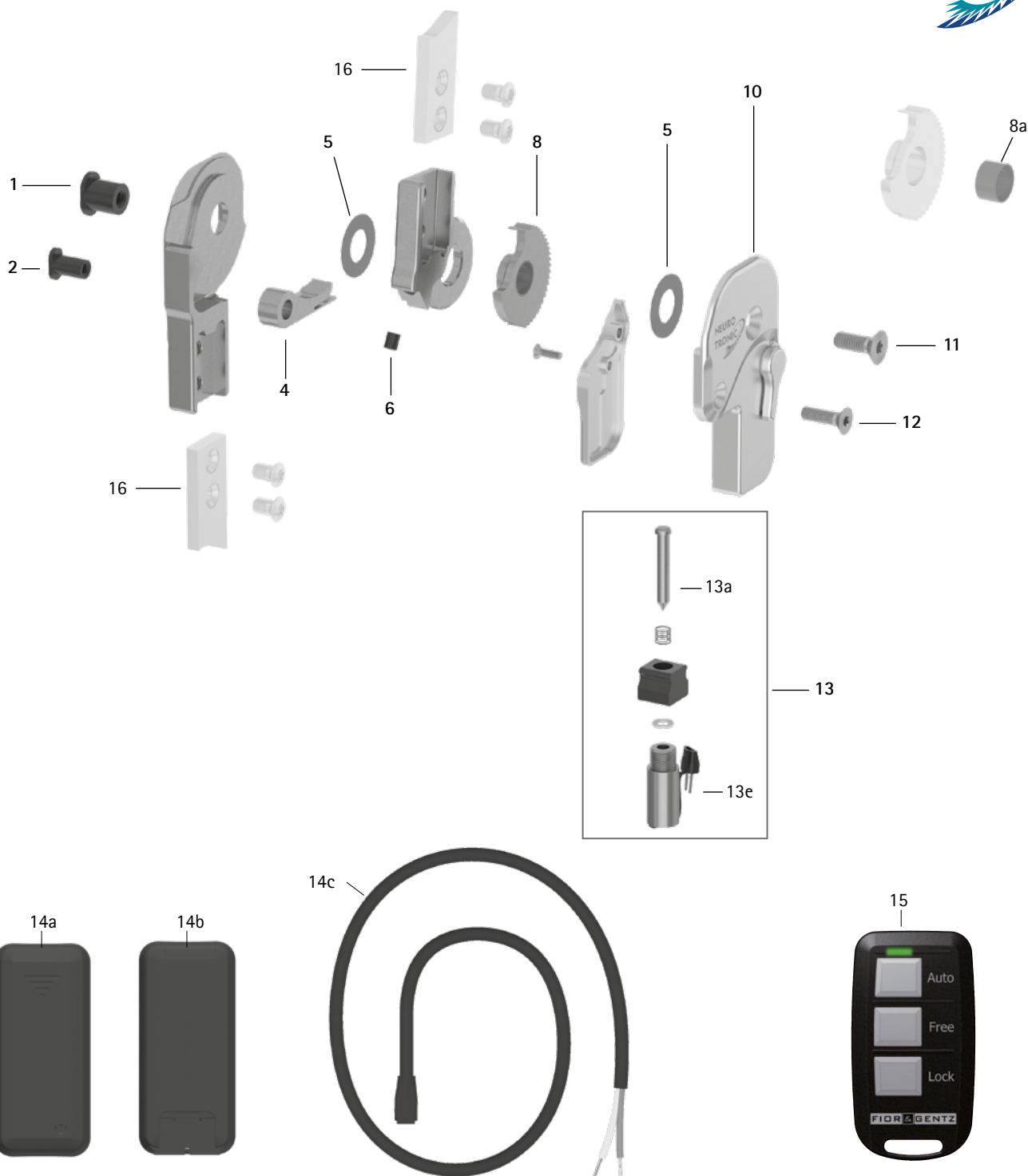

Item	20mm	Description	Potential Problem	Measure	Inspection/ Replacement, If Necessary	Latest Replace- ment after
System Joint						
1	SB1069-L1000	bearing nut (joint axis)	wear	replacing	every 6 months	36 months
2	SB8559-L1000	bearing nut (locking pawl)				
4	SK0375-2	locking pawl	wear of the teeth	replacing	every 3 months	12 months at activity level 1 and 2 9 months at activity level 3 6 months at activity level 4

WP0113-GB-2021-12

patient commission/configuration ID _____

Item	20mm	Description	Potential Problem	Measure	Inspection/ Replacement, If Necessary	Latest Replace- ment after
5	GS2411-040	sliding washer, Ø = 24mm	wear	replacing	every 6 months	18 months
5	GS2411-045					
5	GS2411-050					
5	GS2411-055					
5	GS2411-060					
6	PN1000-L06	extension stop damper	wear	replacing	every 6 months	18 months
8	SK0365-2L	toothed ring with sliding bushing, left lateral or right medial, titanium	wear of the teeth	replacing	every 3 months	12 months at activity level 1 and 2
8	SK0365-2R	toothed ring with sliding bushing, left medial or right lateral, titanium				9 months at activity level 3
8a	BP1211-L059	sliding bushing	wear	replacing	every 6 months	18 months
10	SK3895-L	cover plate with lever, left lateral or right medial	loss of function, wear	replacing	every 6 months	36 months
10	SK3895-R	cover plate with lever, left medial or right lateral				
11	SC1406-L14	countersunk flat head screw with hexalobular socket (axle screw)	wear	replacing	every 6 months	36 months
12	SC1405-L14	countersunk flat head screw with hexalobular socket	wear	replacing	every 6 months	36 months
13a	SK0385-01	plunger for solenoid	soiling	cleaning	every 6 months	-
13e	SK0385-00	solenoid without plunger, with connector	soiling	cleaning	every 3 months	-
14a	ET3830	controller without Bluetooth with exchangeable batteries	outdated software	updating soft- ware	every 6 months	36 months
14a	ET3845	controller with Bluetooth with exchangeable batteries	low battery health	replacing con- troller		
14b	ET3840	controller with Bluetooth with lithium-polymer battery				
14c	ET0420-5	connection cable for solenoid, tinned ends, 360mm	damage	replacing	every 6 months	-
w/o fig.	ET0420-4	connection cable for solenoid, 550mm				
Remote Control						
15	ET3800-P	remote control for the patient for the controller with exchangeable batteries, 1 leg	outdated software	updating soft- ware	every 6 months	36 months
15	ET3840-P	remote control for the patient for the controller with rechargeable lithium- polymer battery, 1 leg				
System Anchors and System Side Bars						
16	see catalogue	system anchor and system side bar	wear or breakage	replacing	every 6 months	-