

patient commission/configuration ID _____

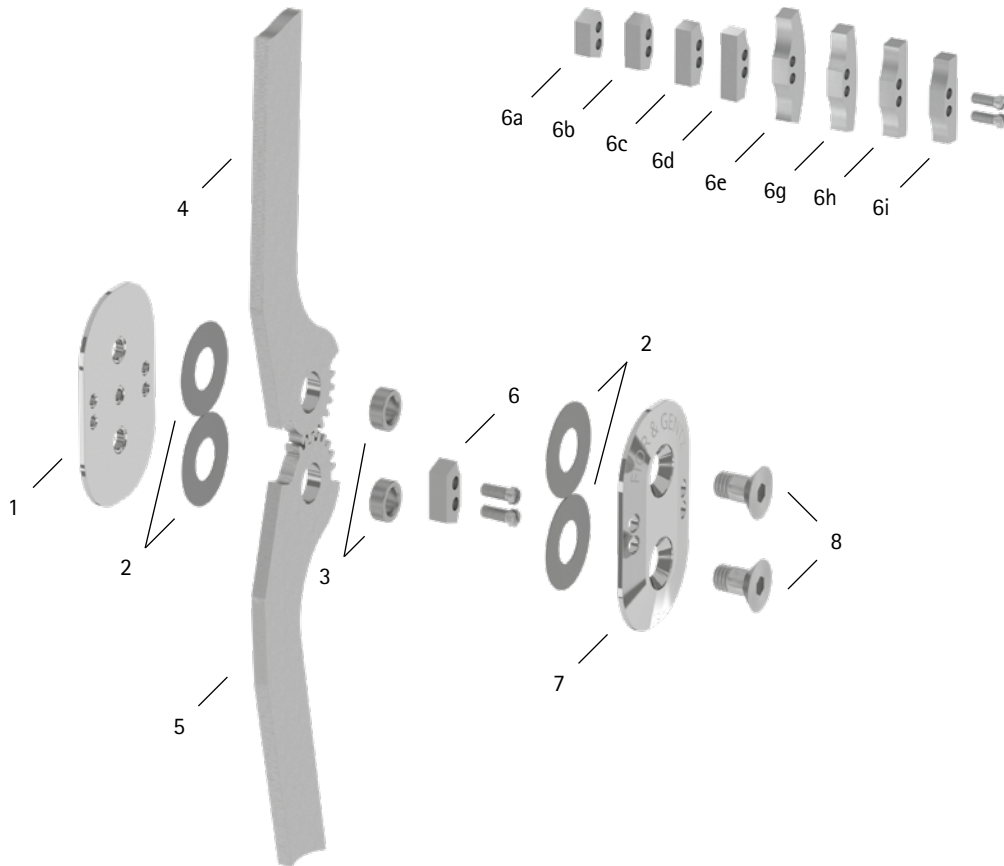

| Item | 10mm | Description | Potential Problem | Measure | Recommended Inspection, Potential Replacement* | Latest Replacement after |
|---------------------|--------------|--|-------------------|-----------|--|--------------------------|
| System Joint | | | | | | |
| 1 | KS0150-AL | base plate | wear | replacing | every 6 months | 36 months |
| 2 | GS1609-050 | sliding washer | wear | replacing | every 6 months | 18 months |
| 3 | BB8553-89 | bronze bushing, $\varnothing = 8.5\text{mm}$, $h = 3.89\text{mm}$ | wear | replacing | every 6 months | 36 months |
| 3 | BB8553-92 | bronze bushing, $\varnothing = 8.5\text{mm}$, $h = 3.92\text{mm}$ | | | | |
| 3 | BB8553-95 | bronze bushing, $\varnothing = 8.5\text{mm}$, $h = 3.95\text{mm}$ | | | | |
| 3 | BB8553-98 | bronze bushing, $\varnothing = 8.5\text{mm}$, $h = 3.98\text{mm}$ | | | | |
| 4 | BK0200-AL | femoral side bar wing, aluminium | wear | replacing | every 6 months | 36 months |
| 5 | BK0210-AL | tibial side bar wing, aluminium | | | | |
| 6a | KS9502-E000 | 0° extension stop/100° flexion stop with 2 slotted pan head screws | wear | replacing | every 6 months | if required |
| 6 | KS9502-E005 | 5° extension stop with 2 slotted pan head screws | | | | |
| 6b | KS9502-E010 | 10° extension stop/90° flexion stop with 2 slotted pan head screws | | | | |
| 6c | KS9502-E020 | 20° extension stop/60° flexion stop with 2 slotted pan head screws | | | | |
| 6d | KS9502-E030 | 30° extension stop/70° flexion stop with 2 slotted pan head screws | wear | replacing | every 6 months | not necessary |
| 6e | KS9502-F000 | 0° flexion stop with 2 slotted pan head screws | | | | |
| 6g | KS9502-F010 | 10° flexion stop with 2 slotted pan head screws | | | | |
| 6h | KS9502-F020 | 20° flexion stop with 2 slotted pan head screws | | | | |
| 6i | KS9502-F030 | 30° flexion stop with 2 slotted pan head screws | | | | |
| 7 | KS0151-AL/FG | cover plate | wear | replacing | every 6 months | 36 months |
| 8 | SC1015-L11 | countersunk flat head screw with hexagon socket and shank | wear | replacing | every 6 months | 36 months |

* depending on the assessment of the distributor of the custom-made product regarding the patient's usage behaviour

WP0089-GB-2023-01